



Four Embarcadero Center

Four Embarcadero Center, Suite 1400
San Francisco, CA 94111

T: 415.766.3500
E: EmbarcaderoTeam@carrworkplaces.com

Boasting the most prominent business address in San Francisco, Four Embarcadero Center is located in the premier multi-use complex in the heart of San Francisco's prime commercial district. Four Embarcadero Center is convenient to a diverse array of business and entertainment facilities. The building overlooks the historic Ferry Building, the unique multi-use project that offers retail and food services galore. Four Embarcadero Center is easily accessed by all modes of public transportation.

CENTER FEATURES

- Fully-equipped professional offices
- Available NOW; no start-up capital
- Short and flexible terms (1-36 months)
- Positive people to support your business needs
- Professional, memorable guest reception
- Daily-use offices for mobile and home-based workers
- Conference rooms available by the hour
- Full meeting support, including set-up, IT and catering
- Co-working spaces and plans
- 24/7 managed IT infrastructure
- High-speed bandwidth
- State of the art telephony
- Customized phone answering
- Audio and web conferencing programs
- Litigation support programs
- Community Café with complimentary coffee

"Never doubt that a small group of committed people can change the world. Indeed, it's the only thing that ever has."

MARGARET MEADE



Four Embarcadero Center

Four Embarcadero Center, Suite 1400
San Francisco, CA 94111

T: 415.766.3500

E: EmbarcaderoTeam@carrworkplaces.com

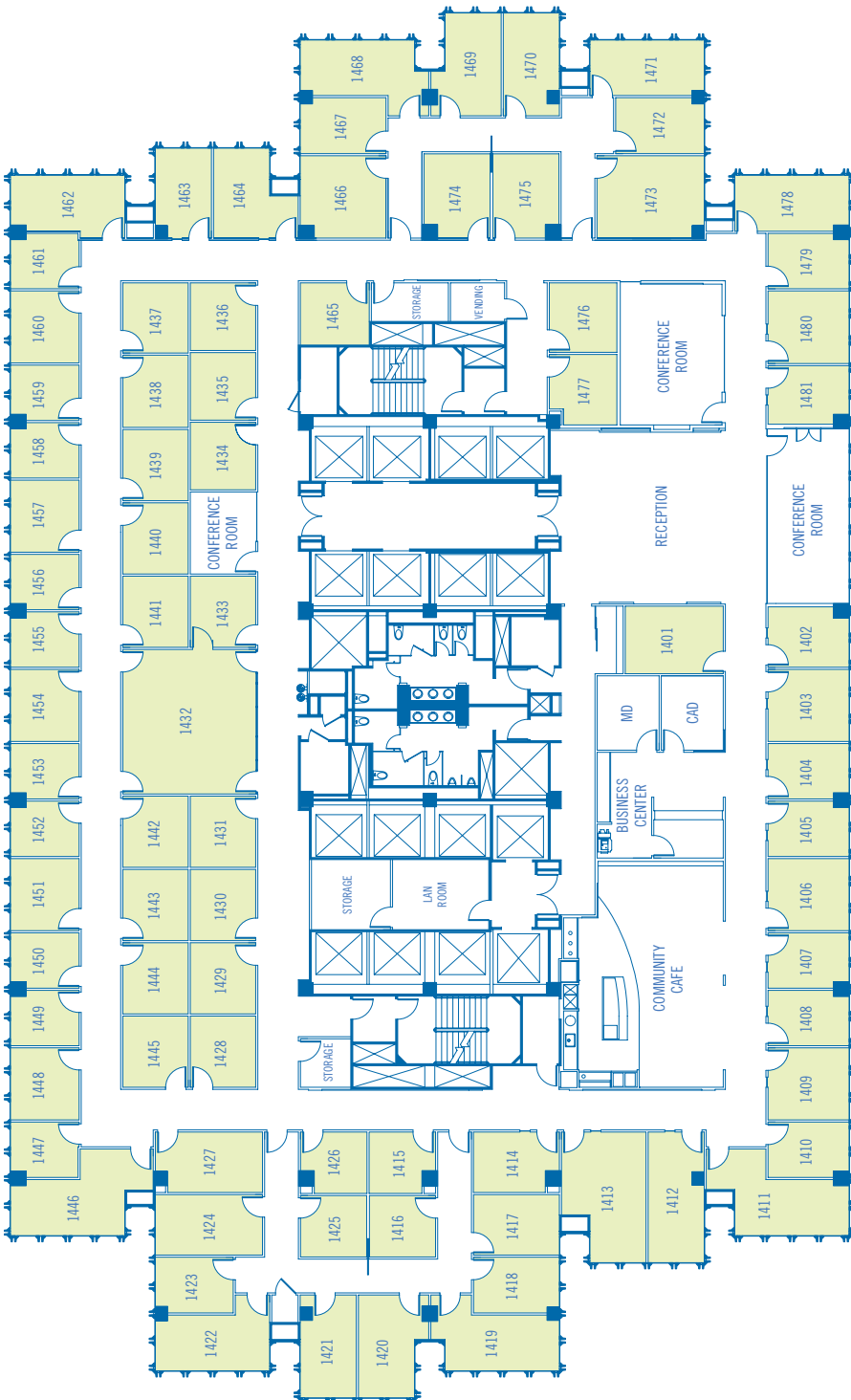

AMENITIES

- Walking distance to The Ferry Building Marketplace, the people's marketplace serving residents and travelers alike
- The Embarcadero Center hosts several in-store events, an annual Holiday ice rink, building lighting ceremony and much more
- Adjacent to the Hyatt Regency and Le Meridien San Francisco hotels
- Steps away from over 100 retailers and health facility within the Embarcadero Complex
- Four Embarcadero Center is easily accessed by all modes of public transportation. Rapid Transit (BART), Muni buses and underground, cable car and ferryboat (Marin, East Bay destinations) are within 1-2 blocks from the building
- Convenient underground garages provide ample tenant and visitor parking
- Round-the-clock taxi lineup at the Hyatt Regency Hotel is also available
- On-site 24 hour security personnel
- On-site conferencing facilities

To support each individual's quest by providing memorable service in uplifting places, where the exchange of ideas is a vital part of the experience.